

**TV
PROP
FEST.**

**POW WOW AT CAMPUS
READING INTERNATIONAL**

THURSDAY 13TH OCTOBER 2022

CAMPUS
**EVENT
PROGRAMME
2022**

POWERED BY

**UK PROPERTY
FORUMS.**



#BETTER
TOGETHER

From our earliest days as architects and planners pioneering the profession, to today where we span all sectors and numerous specialisms, we have striven to be leaders in our field.

Now, we join Stantec - designers, engineers, environmental scientists and project managers - who believe, as we do, that nurturing the communities we create, serve and employ, is fundamental to success.

Together, alongside you, our clients - we are better together.



#bettertogether
www.bartonwillmore.co.uk

**BARTON
WILLMORE** now



Stantec

TV PROP FEST.

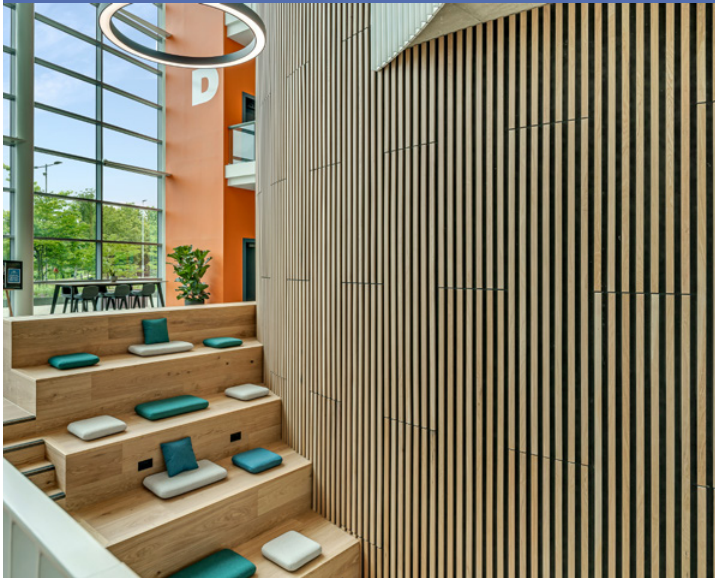
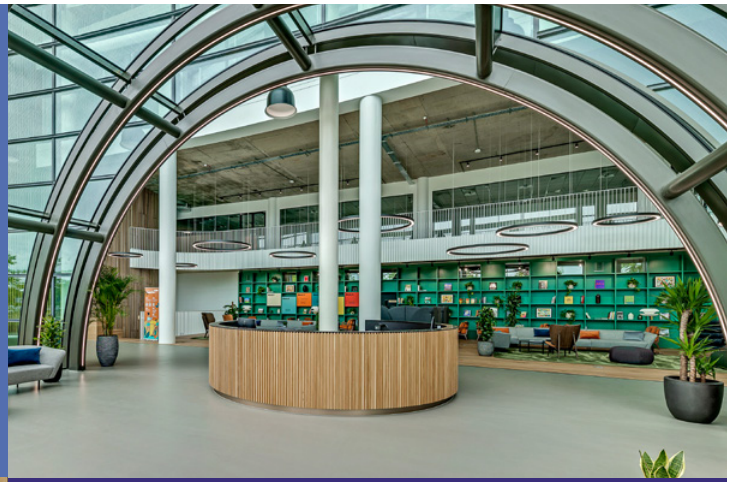

WELCOME TO TVPROPFEET!



This event at **Campus Reading International** aims to promote the building to the Reading + Thames Valley property, occupier, and real estate community.

The various planned sessions will explore the changing relationship between the occupier community in the Thames Valley and the key stakeholders who help to shape the region.

Matthew Battle
Founder + Managing Director
UKPF





Helping you to change perceptions of development

We are stakeholder engagement specialists to the property development industry and help our clients secure planning permissions and strategic plan allocations. We also provide support during the construction phase.

We change the perceptions of development through constructive engagement with stakeholders, leaving a positive legacy for our clients and communities.

We offer:

- Strategy development
- Political engagement
- Community consultation
- Digital and social media engagement
- Construction PR
- Media relations
- Monitoring
- Design
- Reputation management
- Corporate guidance

www.devcomms.co.uk
info@devcomms.co.uk
01296 678320

TALKS



10.00am

MORNING COFFEE SERVED IN THE STUDIO @ CAMPUS READING INTERNATIONAL

10.30am

TALK ONE: Placemaking

What must Reading and the Thames Valley region do to continue to attract new investment and occupiers into the region? As occupiers return to the workplace, do the towns of Berkshire need to change and have a different relationship with occupiers?

CHAIR

ALISON WEBSTER, Chief Executive, Berkshire LEP

PANEL + SPEAKERS

TONY PAGE, Deputy Leader of the Council & Lead Councillor for Climate Strategy & Transport, Reading Borough Council

NIGEL HORTON-BAKER, Chief Executive, REDA
PAVITAR MANN, Deputy Leader, Slough Borough Council and Director, DevComms

11.20am

TALK TWO: Thames Valley upon Hollywood

What are the changes happening across the region to the occupier profile as the Thames Valley embraces a new tenant mix including media, film and digital tenants? Are we on the verge of new growth as business clusters locate in the region and replace the old clusters?

CHAIR

ROB ALLAWAY, Managing Director, DevComms

PANEL + SPEAKERS

NICK PATERSON-NEILD, Planning Director, Barton Willmore now Stantec

NICK SMITH, Joint Managing Director, Shinfield Studios
JEREMY PELZER, Stage Space Strategy, British Film Commission

12.10

TALK THREE: Shiny New Ways of Working

Has the workplace changed forever and are we on the cusp of a workplace revolution? What will the Thames Valley office look and feel like in the future? Do projects like Campus Reading International represent a glimpse into the future of office space?

CHAIR

JON GARDINER, Head of Central London Leasing, Savills

PANEL + SPEAKERS

CAROLINE PONTIFEX, Director – Workplace Strategy, KKS Savills

GUY BISHOP, Director, Alchemy Asset Management
MARIA SABEY, Head of Property UK + Ireland, Fujitsu
ALI BIRD, Workplace Manager, Egnyte

13.00

NETWORKING LUNCH

WALKS

13.45 – 14.45

WALKS

An exclusive tour of the recently completed space at Campus Reading International





R·E·D·A™

Reading's Economy & Destination Agency

Shaping a better Reading

Reading's Economy & Destination Agency is the economic development and place marketing organisation for Reading, providing leadership, co-ordination and delivery in three main areas:

- Marketing the place of Reading
- Attracting investment to Reading
- Supporting local businesses in Reading

Find out more at redauk.org.uk



**UK PROP
SOCIAL.**

**FIGGY PUDDING
CHRISTMAS LUNCH**

POWERED BY

**UK PROPERTY
FORUMS.**

Back by popular demand! Figgy Pudding Christmas Lunch 2022

An opportunity for UKPropSocial members and their guests to get together to eat good food, network and share a festive drink surrounded by the unique atmosphere which is Leander Club.

DATE: Tuesday 6th December 2022

VENUE: Leander Club, Henley-on-Thames

SPONSORED BY



BLANDY & BLANDY
solicitors



For more information
www.ukpropertyforums.com/figgy-pudding/

**BOOK NOW
LIMITED AVAILABILITY**

**UK PROP
SOCIAL.**

DISCUSS. ENGAGE. NETWORK.
BE PART OF THE DEBATE.

**RENEW NOW FOR
MEMBERSHIP 2022/23**

Find out more at
www.ukpropertyforums.com/uk-prop-social-membership/

1.2 MILLION ITEMS OF LAUNDRY

Every week CLEAN launders up to 1.2m items of linen from its 42,000 sq ft "super laundry" on SEGRO's Slough Trading Estate.

The new state-of-the-art building allowed CLEAN to build one of the largest, most technologically advanced, greenest and most efficient laundries in the UK.

CLEAN chose the building because of SEGRO's flexible approach to fulfilling its needs and because its location meant significant reductions to both delivery times and fleet emissions.

When brilliant businesses find outstanding spaces, extraordinary things happen.

SEGRO

**UK PROP
SOCIAL.**

**DIARY DATES
2022/2023**



**BRACKNELL
10TH NOVEMBER**



**HALF DAY EVENT @ Waitrose Conference Centre
Bracknell BID and UKPropSocial 'Invest in Bracknell'**

Organised by Bracknell BID in collaboration with UKPF, this event will bring together the main stakeholders, advisors and occupiers located in the Bracknell Business Improvement District.



**OXFORD
17TH NOVEMBER**



**LUNCH EVENT @ Oxford Technology Park
Market Update on the Oxfordshire Property Market**

Tap into Oxford is a lunchtime event hosted by Oxford Technology Park which will explore the Oxfordshire market with experts from the Life Science, Office and Residential Planning sectors.



**FIGGY PUDDING
LUNCH
6TH DECEMBER**



LUNCH EVENT @Leander Club, Henley-on-Thames

Back by popular demand! This is an opportunity for UKPF members and their guests to get together to eat good food, network and share a festive drink with the support of Shiplake College Choir.

Visit www.ukpropertyforums.com/uk-prop-social-events/ for more details, venues and how to book.



CAMPUS

READING INTERNATIONAL

WELCOME TO THE FUTURE OF WORKING

Campus is a 375,000 sq ft
next generation workplace. An amenity rich
community for every type of business.

[CAMPUS-READING.COM](https://campus-reading.com)